



Padelford Lane

Stanmore

£3,750 Per month

A four bedroom, two bathroom, detached house available immediately with Davidson Frost-Wellings.

On the ground floor the house has a large kitchen and dining area perfect for modern family life. In addition, there are two further reception rooms which can be opened to one large room thanks to folding doors. There is also a guest WC downstairs and an adjoining tandem garage. Upstairs the house has a large master bedroom with built-in wardrobes and ensuite shower room. There are also three further bedrooms and a family bathroom.

The house benefits from off-street parking and a large private rear garden with patio, lawn and borders.

Padelford Lane is a modern and secure development with a gated entrance to part of Stanmore Common which gives access to acres of open space just a few yards from your doorstep.

Harrow Council Tax Band G
Security deposit of £4,326.92 at the asking price
Available immediately

- Four bedrooms
- Two bathrooms
- Available immediately
- Gated development
- Modern property
- Detached home

Viewing

Please contact our Davidson Frost-Wellings Office on 020 8954 8806 if you wish to arrange a viewing appointment for this property or require further information.



Floor Plan

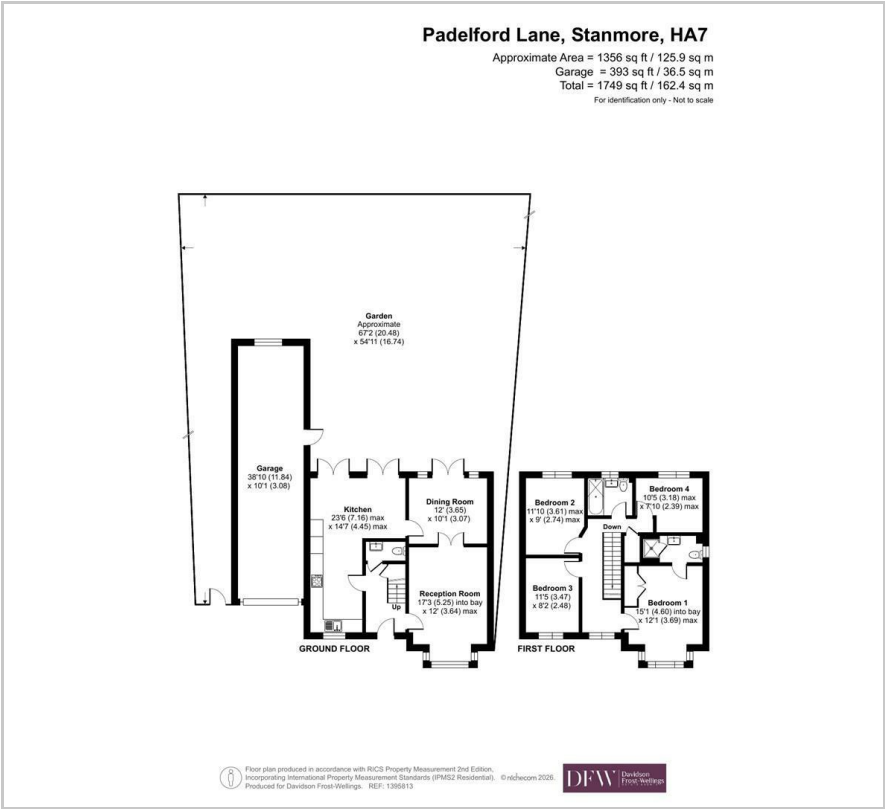

Area Map

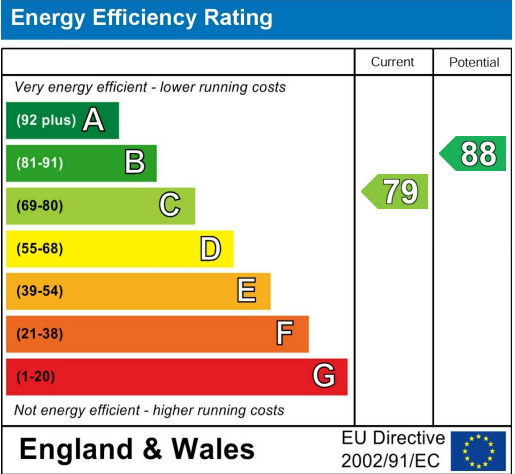

These particulars, whilst believed to be accurate are set out as a general outline only for guidance and do not constitute any part of an offer or contract. Intending purchasers should not rely on them as statements of representation of fact, but must satisfy themselves by inspection or otherwise as to their accuracy. No person in this firms employment has the authority to make or give any representation or warranty in respect of the property.